



## INSTALLATION INSTRUCTIONS

### DexAir Pivot Bushing Replacement

#### K14-207-00: DexAir Pivot Bushing Replacement Kit

### CAUTION

**Do not lift or support the trailer on any part of the axle or suspension system. Never go under any trailer unless it is properly supported on jack stands which have been rated for the load. Improperly supported vehicles can fall unexpectedly and cause serious injury or death.**

1. Jack up trailer and secure on adequate capacity jack stands. Follow trailer manufacturer's recommendations for lifting and supporting the unit.
2. Remove shock absorbers. Keep shocks and mounting hardware for re-installation.
3. Disassemble the pivot connection and carefully remove the trailing arms from the suspension hangers.
4. Mark reference line on the back of the tube for orientation of new bushing.

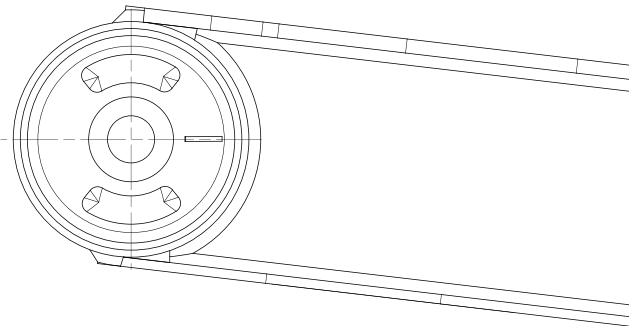

5. Remove bushing from the trailing arms using a bushing replacement tool.

**Note: Industry standard bushing installation and removal tool is recommended.**

6. Clean the internal surfaces of the bushing tube on the trailing beam. All rust, rubber, scale, etc. must be removed.
7. Inspect the bushing tube for excessive wear or damage. If worn, trailing arm and axle need replaced.

**Note: Do not attempt to repair any cracks or splits in the tube. Replacement is required.**

8. Remove any burrs or sharp edges on the internal surfaces of the bushing tube, as they may damage the bushing upon installation.
9. Apply lubricant (P-80® lubricant recommended) to the inside wall of the bushing tube and outside face of the rubber bushing. **DO NOT USE GREASE OR OIL-BASED LUBRICANTS.**
10. Install bushing into tube so it's centered in the trailing beam.

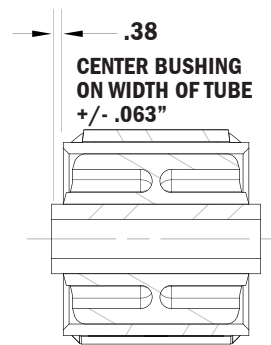

11. Install beam spacers over edges of the metal bushing tube. They should rest loosely on the metal tube.
12. Carefully position trailing arms back into the suspension hangers.
13. Install pivot connection hardware components, per [059-A59-01 DexAir Installation Instructions](#), making sure components are clean and free of debris. Torque between 425-440 ft.-lbs (clean and dry fastener valve).
14. Perform alignment as per [DexAir Installation Instructions](#).
15. Re-install shock absorbers. Tighten lock nuts enough to prevent bolt from side to side movement.

**SCAN BELOW FOR  
INFORMATION ON DEXAIR**

